

Flat Body Cylinders

- Body made of high quality solid steel.
- Extremely low design for use in confined spaces where standard cylinders will not fit.
- Maximum working pressure: 700 bar (10,000 psi).

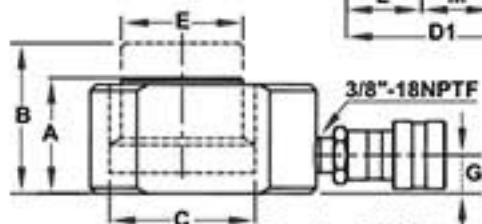

HF0503
Coupler: CR38-F

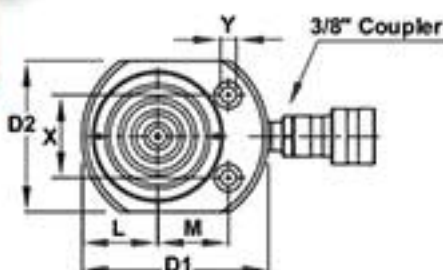

Coupler: CH38-F
(Except HF0503 Coupler: CR38-F)

Incl. 1 Carry Handle

- 75, 100 and 150 Ton Flat Body Cylinders are equipped with a Carrying Handle.



Model Number	Stroke (mm)	A	B	Oil Capacity (cc)	Weight (Kg)
		Min. Height (mm)	Max. Height (mm)		
CYLINDER CAPACITY: 5 TON = 49 kN					
HF0500	16	41	57	11	0.9
CYLINDER CAPACITY: 5 TON = 49 kN 3/8" COUPLER REGULAR FLOW					
HF0503	6	32	38	4	0.6
CYLINDER CAPACITY: 10 TON = 104 kN					
HF1005	11	43	54	16	1.5
CYLINDER CAPACITY: 20 TON = 194 kN					
HF2005	11	51	62	31	2.7
CYLINDER CAPACITY: 30 TON = 287 kN					
HF3005	13	59	71	54	4.4
CYLINDER CAPACITY: 50 TON = 445 kN					
HF5006	16	67	83	101	6.7
CYLINDER CAPACITY: 75 TON = 727 kN (INCL. HANDLE)					
HF7506	16	79	95	166	11.5
CYLINDER CAPACITY: 100 TON = 887 kN (INCL. HANDLE)					
HF10006	16	85	101	202	14.3
CYLINDER CAPACITY: 150 TON 1385 kN (INCL. HANDLE)					
HF15006	16	100	116	316	24.2

Model Number	Capacity kN	Cylinder Effective Area (cm ²)	C	D1 x D2	E	G	L	M	Cylinder Mounting Hole Dimensions			
			Cylinder Bore Ø (mm)	Outside Dim. (mm)	Plunger Ø (mm)	Base to Inlet Port (mm)	Plunger to Base (mm)	Plunger to Mtg. Hole (mm)	Hole Pitch (mm)	Hole Ø (mm)	Counter Bore Ø (mm)	Counter Bore Depth (mm)
HF0500	49	7.1	30	60 x 40	25	19	20	22	28	5	10	6
HF0503	49	7.1	30	61 x 41	25	18	20	22	28	5	10	6
HF1005	104	15.2	44	84 x 56	38	20	28	34	37	7	10	10
HF2005	194	28.3	60	102 x 76	51	19	39	40	49	10	15	10
HF3005	287	41.9	73	117 x 97	64	20	48	45	52	10	16	11
HF5006	445	63.6	90	140 x 114	70	20	57	54	67	11	19	13
HF7506	727	103.9	115	165 x 140	90	20	70	67	76	13	21	14
HF10006	887	126.7	127	177 x 152	90	20	76	75	76	13	21	14
HF15006	1385	197.9	158	215 x 190	118	24	95	83	117	13	21	14